

IBR ROOF WALKWAY ASSEMBLY (IEM-IBR1)

STEP 1: BOLTING OF MOUNTING RAIL TO IBR ROOF SHEET

PARTS REQUIRED:

- Rubber protective seals (A)
- Mounting profile (Cut to length) (B)
- M5x20 self tapping screw with rubber washer (C)

TOOLS REQUIRED:

- Electrical/Battery operated drill
- 8mm socket with adaptor to attach to drill chuck
- Tape measure

INSTRUCTIONS:

1. Measure the required section length of walkway to mount to the roof (D)
2. Cut walkway to length if required
3. Position the mounting rail (B) 150mm from either edge of the walkway (Front & Back)
4. Place the rubber protective seal (A) onto the roof
5. Place the mounting rail (B) on top of the rubber seal (A)
6. Mark the position for the M5x20 self tapping screw
7. Screw the mounting rail firmly to the roof

NOTE:

- Remaining mounting rails to be equally spaced between the 2 outer mounting rails
- Mounting rails to have a maximum centre to centre of 1,5m apart

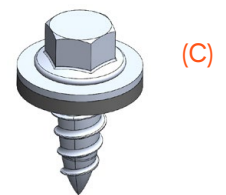
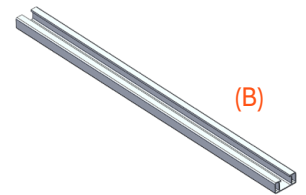
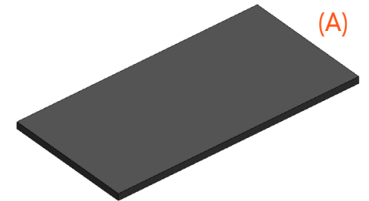

STEP 2: BOLTING OF THE WALKWAY TO THE MOUNTING RAIL

PARTS REQUIRED:

- Walkway (D)
- 2x M8x20 Cap screws per mounting rail (E)
- 2x M8 Flat washers per mounting rail (E)
- 2x M8 Spring washers per mounting rail (E)
- 2x Profile nuts per mounting rail (F)

TOOLS REQUIRED:

- Electrical/Battery operated drill
- 6mm Allen key
- Tape measure

INSTRUCTIONS:

- Place the walkway onto the mounting rails (150mm from either mounting rail)
- Position the walkway on top of the mounting rails
- Pre-assembly the M8x20 cap screw, flat, spring & clamp washer (E)
- Slide the assembled clamp unit into the mounting rail and over the walkway (E)
- Ensure the clamp washer is over the walkway edge, then torque the cap screw to 24nm
- Continue the process for the remaining rails
- Ensure 20mm expansion gaps between consecutive walkways (F)

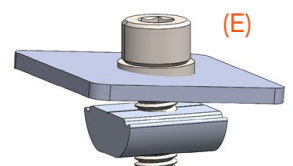
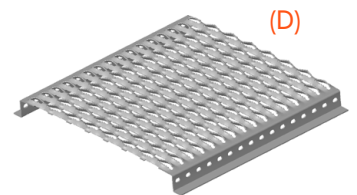

IBR ROOF WALKWAY ASSEMBLY (IEM-IBR1)

STANDARD LENGTH 5.7m

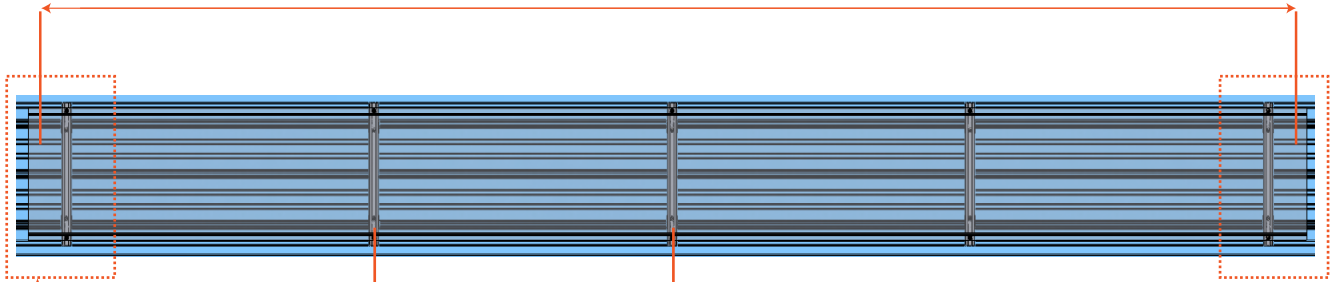

EQUALLY SPACED AFTER EITHER END HAS BEEN POSITIONED
MAX 1,5M APART

150mm (FACE TO FACE)

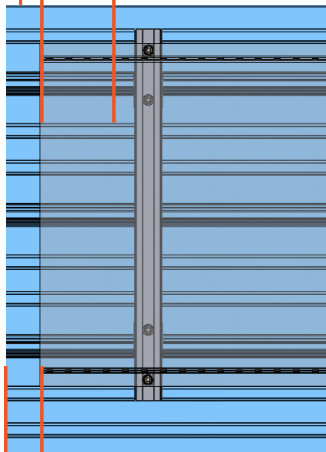

(F)

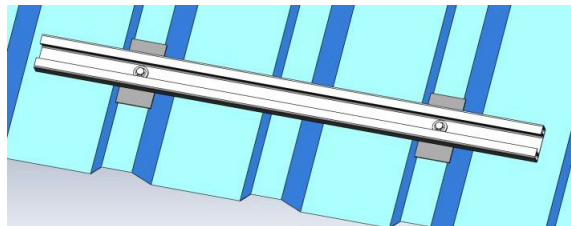
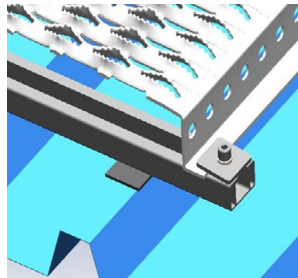

20mm EXPANSION GAP
TO NEXT WALKWAY

OVAL HOLES ON SIDE OF WALKWAY
TO MATCH ON CONSECUTIVE LENGTHS (K)

(K)

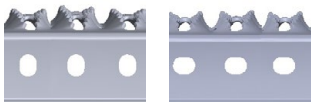
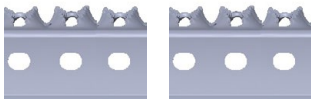

SAFETY INSTRUCTIONS FOR ALL ROOF WALKWAY INSTALLATIONS

ASSEMBLY OF WALKWAYS TO ROOFS

INSTRUCTIONS:

1. Ensure all walkways at all times are securely fastened to the mounting rail supporting the walkway (A)
2. Mounting rails to be used parallel and perpendicular to roof sheeting as per illustration below (A)

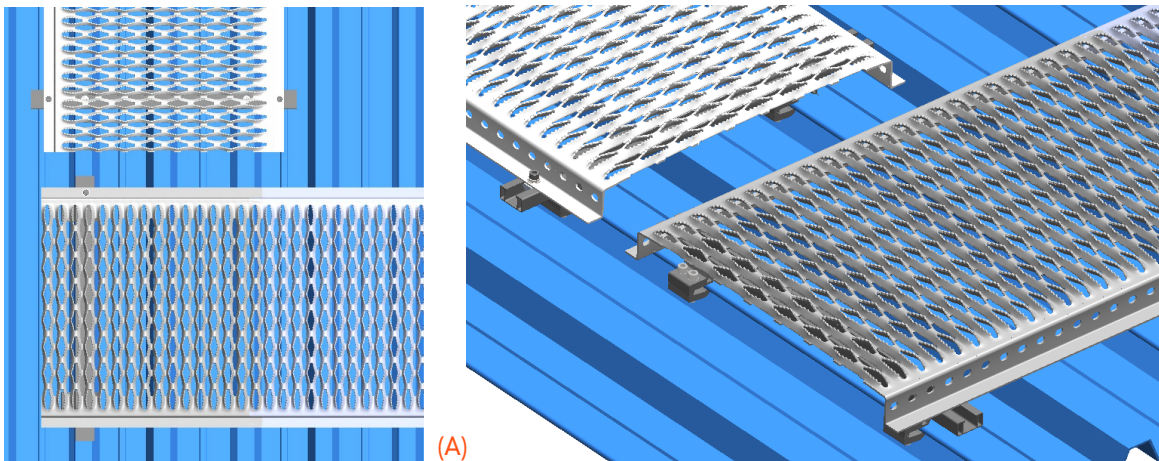

INSTALLING OF WALKWAYS ON ROOFS WITH GRADIENTS

INSTRUCTIONS:

1. All walkways to be installed with a minimum of 2x bolts, flat & spring washers clamping through a drilled hole in the walkway and fastened into a profile nut (C)
2. Remaining walkway length can be fastened by clamping over the walkway as per image (B)
3. All walkways installed on a roof with a gradient of 5 degrees or more, are to use the mounting method shown in image (C) for all mounting rails supporting the walkway

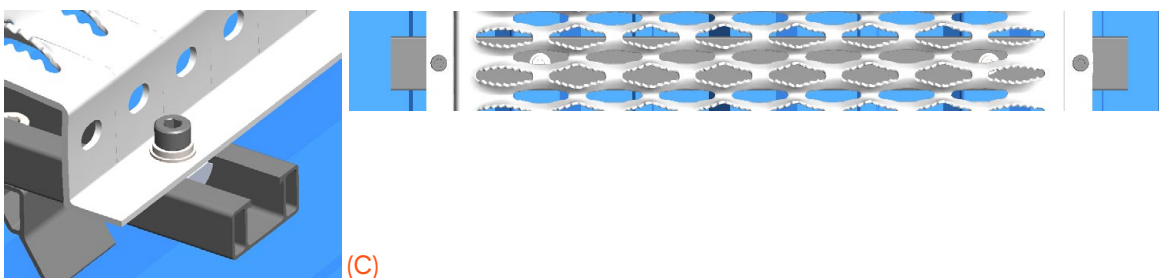
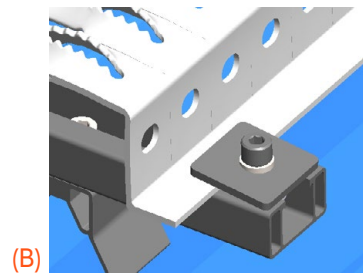

IBR WALKWAY ASSEMBLY KIT BOM (IEM-IBR1)

Item	Description	Quantity	Part CAD Image
IEM#1	Rail (top fix) 20x575mm AL6063 T6 Mill	5	
IEM#8	EPDM Rubber 80x40x2mm	10	
IEM#9	Self-drilling screw 25mmx5,5mm class 4 coated	10	
IEM#3	Cap Screw - M8x20mm SS304	10	
IEM#4	Spring Washer M8 SS304	10	
IEM#5	Flat Washer M8x16x1,5 SS304	10	
IEM#6	Aluminium Rail Nut Winged AL6005 T5	10	
IEM#12	Laser Cut Clamp Washer - 40x40mm	10	